

CANOPY ASSEMBLY INSTRUCTION

1) FIX THE THREADED BARS

DISTANCE BETWEEN FIXING HOLES

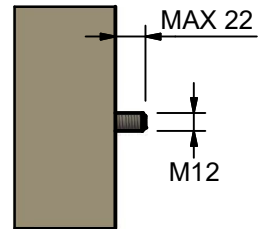
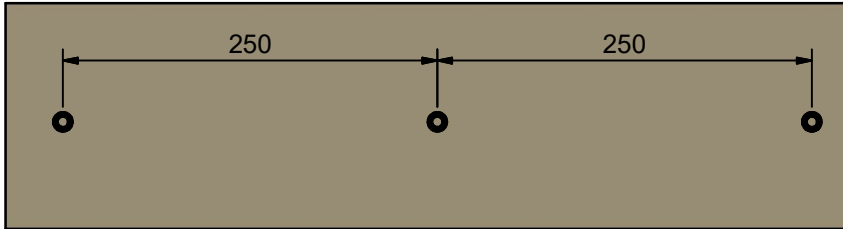

*Supports are provided with 13x16 slotted holes and 250 mm center distance, slotted holes allow an adjustment margin.
Let the threaded bar of maximum 22 mm protrude*

2)

**INSERT THE GRAY, HALF MOON AND WEDGE SUPPORTS FOR GLASS.
INSERT BOTTOM SEALS (OUTER AND BOTTOM BALLOON)
AND THE TWO NYLON SAFETY PINS FOR EACH GLASS**

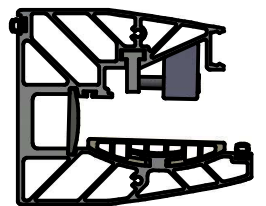
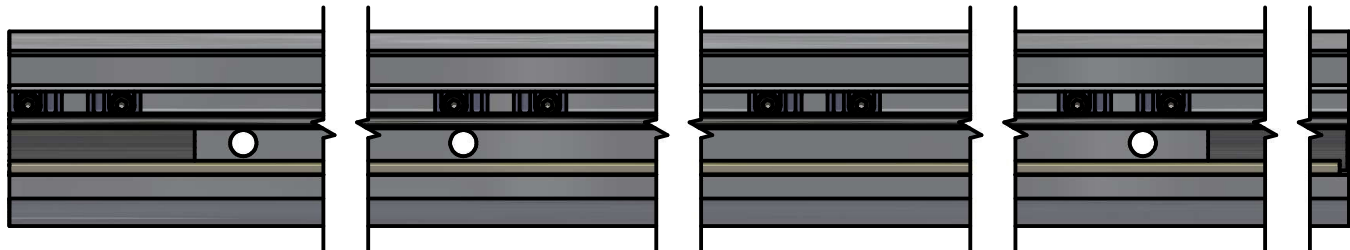

**3) FIX THE CANOPY PROFILE WITH WASHER AND SELF-LOCKING NUT, OR WITH WASHER AND M12 SCREW.
ONCE FIXED, INSERT THE INTERNAL GASKETS AS SHOWN IN THE IMAGE**

INSERT AFTER BLOCKING THE BAR

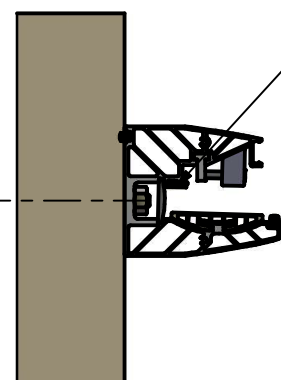
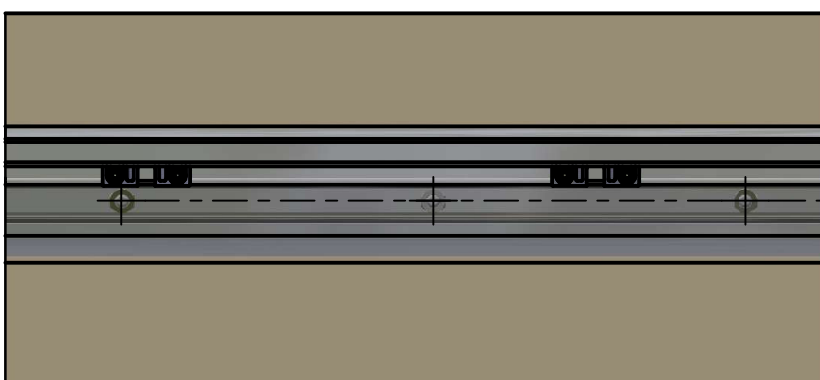

4) DRILL THE STRATIFIED AND TEMPERATED GLASS OF THICKNESS $10 + 1.52 + 10$

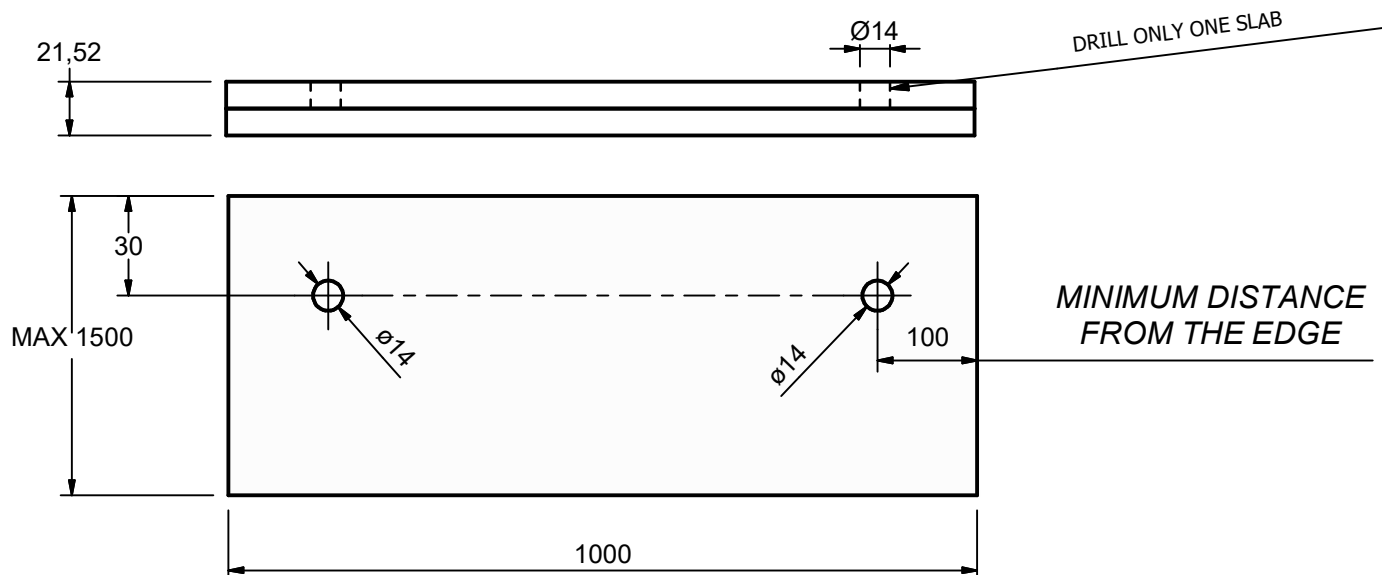

5) INSERT THE GLASS AND TIGHTEN THE WEDGES, THE INSERT CLOSING COVER WITH RELATIVE GASKET

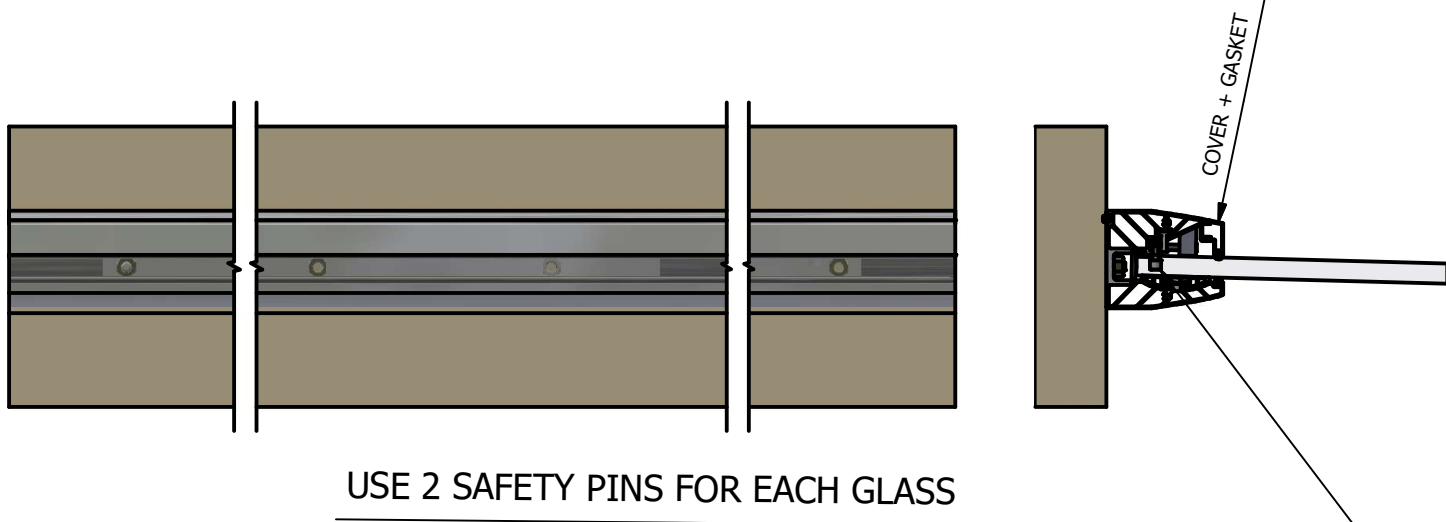

6) CLOSE Laterally with WATERPROOFING GASKET AND CAPS (ARTICLE TG 702)

